

La Cisnera Community Centre

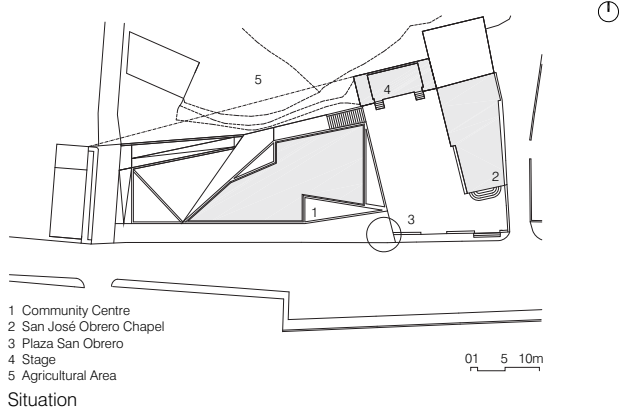

La Cisnera is a small, rural settlement that has grown up along a roadside in the upper reaches of the town of Arico.

The new Community Centre relates to its surroundings, with the main entrance placed at the level of the town's main square. The building is meant to be seen as an extension of the urban public space, and offers a sheltered environment for the town square, onto which it opens. The intention was to offer a flexible delimitation of the spaces outlined in the brief, using mobile partition walls to allow for a free, modular configuration of the space for different uses and activities, thereby ensuring its integration as a singular meeting space and its extension outward to the square.

The orientation of the main entrance and the window frame defining the building's edge blocks the entry of direct sunlight into the main room, making it luminous and cool - a shady, protected place on the square.

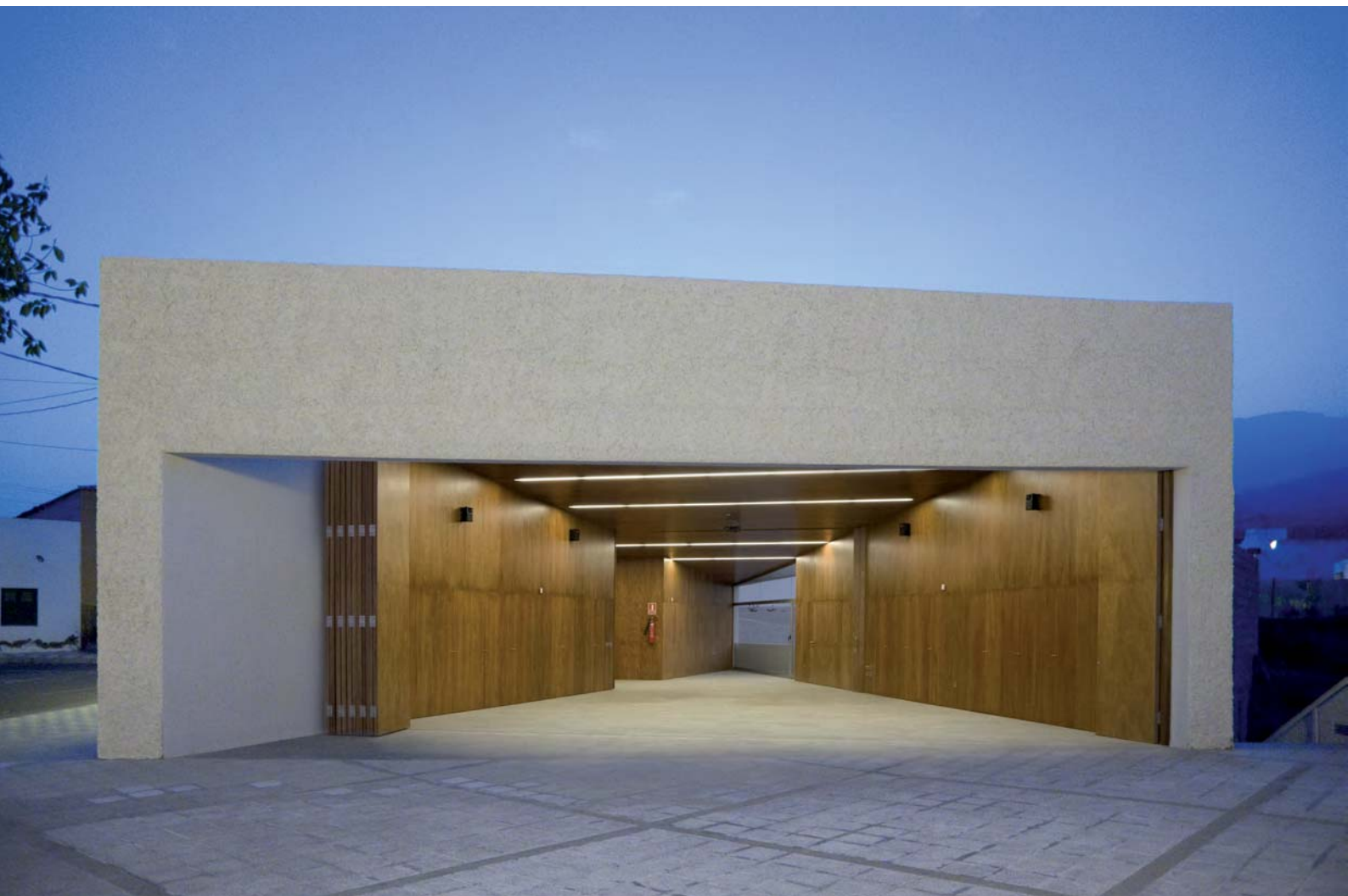

La Cisnera Community Centre

Location
Client

Consultants
Contract
Floor Area
Awards

Arico, Tenerife. Spain
Cabildo Insular de Tenerife :
Servicio Técnico de Planes Insulares
Gpi Ingenieros, Civil Engineers
JOCA Ingeniería y Construcciones S.A.
493,80 m²
WAF World Architecture Festival (2009):
Honourable Mention

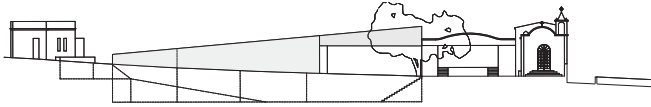

Street View

